

**The 28th
International Conference
on Machine Learning**

Welcome!

Bellevue, Washington, USA
June 28 – July 2, 2011



ICML 2011

BELLEVUE, WASHINGTON

WELCOME to ICML 2011!

The **Twenty-Eighth International Conference on Machine Learning (ICML 2011)** is held at the Hyatt Regency Bellevue between June 28 and July 2, 2011. **Welcome to Bellevue!**

All technical talks will take place in the Grand Ballroom on the second floor of the hotel's conference center. The conference registration desk is located on the second floor next to the Grand Ballroom. Each talk of the main conference is allocated 20 minutes plus 5 minutes for questions and speaker transition. Each talk will also have an accompanying poster in one of the poster sessions to allow one-on-one discussions.

The **Poster Sessions** will take place in the **Evergreen Ballroom** (first floor, lobby level) on Wednesday, June 29 and Friday, July 1, in the evening starting at 6pm. A dinner buffet will be served during both poster sessions.

A **Message Board** is located near the registration desk. An electronic version of the message board will be available on the conference homepage.

Internet access. Wireless Internet is available in the conference area free of charge for conference registrants. Please use the network **Hyatt-MEETING** and passcode **ICML2011**. For the **guestrooms** of conference attendees, the Hyatt offers free wired internet access, but charges a daily fee for wireless internet.

The full **conference proceedings** are available via conference web site at **icml-2011.org**.

The joint ICML/ACL/ISCA **Symposium on Machine Learning in Speech and Language Processing** is held on Monday, June 27, 2011, in Grand-IJ. All ICML main conference registrants are welcome to attend.

The six **ICML Tutorials** are held on Tuesday, June 28, 2011 in two parallel sessions.

The nine **ICML Workshops** are held on Saturday, July 2, 2011.

Throughout the conference, the **coffee breaks** are held in the foyer of the Grand Ballroom, just outside the conference rooms.

The **ICML Banquet sponsored by Amazon.com**, is on Thursday, June 30, at the Museum of Flight in Seattle, a 30-minute drive from Bellevue. Transportation will be provided from the Bellevue Hyatt starting at 4:50 p.m. The buses will be leaving from the Evergreen North Foyer, on the first floor, just outside the Evergreen Ballroom.

The **IMLS Business Meeting** takes place on Friday, July 1, from 5:30 to 6:30 p.m. in Oren Hall. The business meeting is open to all attendees.

The **Machine Learning journal (MLJ) board meeting** takes place on Wednesday, June 29 at noon.

The **Women in Machine Learning (WiML)** event takes place on Thursday, June 30 at noon.

The **IMLS Board Meeting** takes place on Friday, July 1 at noon.

Exhibitors: Amazon.com, Springer, Cambridge University Press, and Morgan-Claypool have desks that will be located in the Grand Ballroom foyer throughout.

Program Schedule

Monday, June 27, 2011 - Joint ICML/ACL/ISCA Event

Symposium on Machine Learning in Speech and Language Processing

Venue: **Grand-IJ** (Grand Ballroom, room IJ)

Registration opens at **7am**. The symposium starts at **8am**.

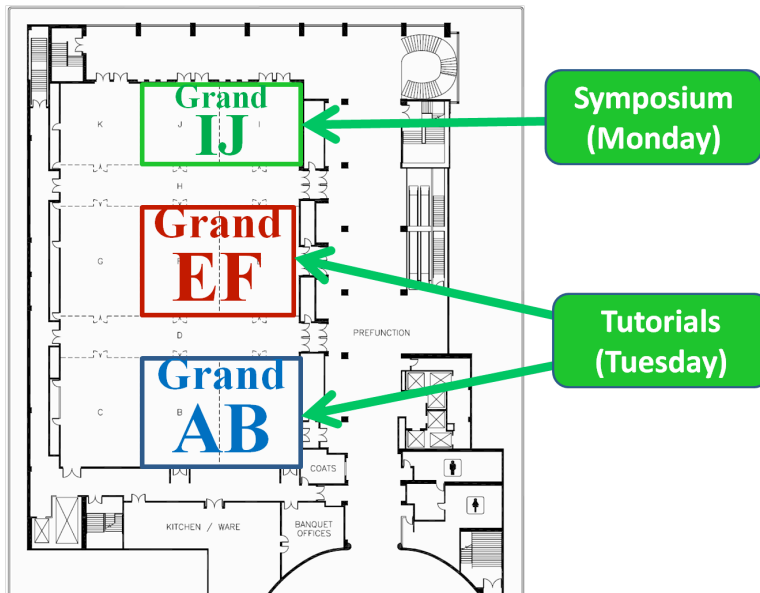

Tuesday, June 28, 2011 – ICML Tutorials

Time	Room	Tutorial	Organizer(s)
9:00am-12:00pm	Grand-AB	Machine Learning for Large Scale Recommender Systems	Deepak Agarwal, Bee-Chung Chen
	Grand-EF	Machine Learning and Robotics	Marc Toussaint
1:00pm-4:00pm	Grand-AB	Introduction to Bandits: Algorithms and Theory	Jean-Yves Audibert, Remi Munos
	Grand-EF	Collective Intelligence and Machine Learning	Haym Hirsch
4:30pm-7:30pm	Grand-AB	Learning Kernels	Corinna Cortes, Mehryar Mohri, Afshin Rostamizadeh
	Grand-EF	Machine Learning in Ecological Science and Environmental Policy	Tom Dietterich, Rebecca Hutchinson, Daniel Sheldon

Main Conference (Wednesday, Jun 29 - Fri. July 2) Room Numbers and Configuration.

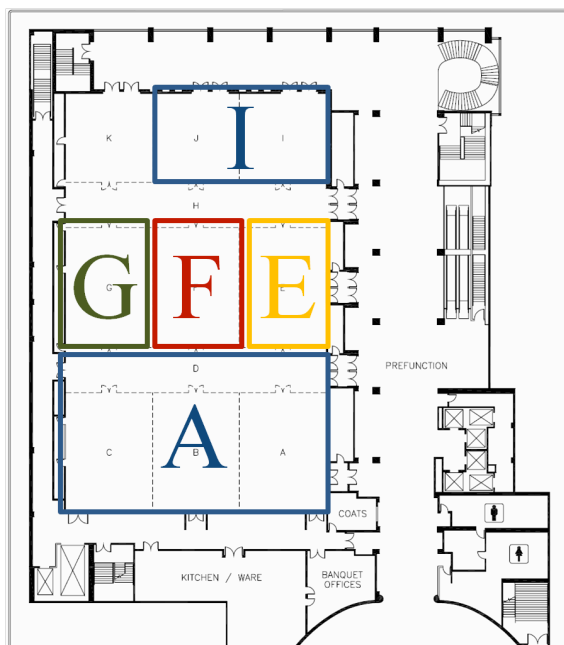

Time	Room	Session	Presentation/Event	Authors/Presenters
8:30–9:00	A	Welcome	Welcome address and Best Paper Awards	Lise Getoor, Tobias Scheffer, Dragos Margineantu
9:00–10:00	A	Keynote Chair: John Platt	Embracing Uncertainty: Applied Machine Learning Comes of Age	Christopher Bishop
10:00–10:30	Coffee Break			
10:30–12:10	A	2A Bandits and Online Learning Area chair: John Langford	Unimodal Bandits	Jia Yuan Yu; Shie Mannor
			On tracking portfolios with certainty equivalents on a generalization of Markowitz model: the Fool, the Wise and the Adaptive	Richard Nock; Brice Magdalou; Eric Briys; Frank Nielsen
			Beat the Mean Bandit	Yisong Yue; Thorsten Joachims
			Multiclass Classification with Bandit Feedback using Adaptive Regularization	Koby Crammer; C. Gentile
	I	2I Structured Output Area chair: Mehryar Mohri	An Augmented Lagrangian Approach to Constrained MAP Inference	Andre Martins et al.
			Max-margin Learning for Lower Linear Envelope Potentials in Binary Markov Random Fields	Stephen Gould
			Inference of Inversion Transduction Grammars	Alexander Clark
			Minimal Loss Hashing for Compact Binary Codes	Mohammad Norouzi; David Fleet
	E	2E Reinforcement Learning Area chair: Ron Parr	Structure Learning in Ergodic Factored MDPs without Knowledge of the Transition Function's In-Degree	Doran Chakraborty; Peter Stone
			The Infinite Regionalized Policy Representation	Miao Liu; X. Liao; L. Carin
			Online Discovery of Feature Dependencies	Alborz Geramifard et al.
			Doubly Robust Policy Evaluation and Learning	M. Dudik; J. Langford; L. Li
	F	2F Graphical Models and Optimization Area chair: Nando de Freitas	Dynamic Tree Block Coordinate Ascent	Daniel Tarlow et al.
			Approximation Bounds for Inference using Cooperative Cuts	Stefanie Jegelka; Jeff Bilmes
			Convex Max-Product over Compact Sets for Protein Folding	Jian Peng; Tamir Hazan; David McAllester; Raquel Urtasun
			On the Use of Variational Inference for Learning Discrete Graphical Models	Eunho Yang; Pradeep Ravikumar
	G	2G Recommendation and Matrix Factorization Area chair: Dale Schuurmans	GoDec: Randomized Low-rank and Sparse Matrix Decomposition in Noisy Case	Tianyi Zhou; Dacheng Tao
			Large-Scale Convex Minimization with a Low-Rank Constraint	Shai Shalev-Shwartz; Alon Gonen; Ohad Shamir
			Linear Regression under Fixed-Rank Constraints: A Riemannian Approach	Gilles Meyer; Silvère Bonnabel; Rodolphe Sepulchre
			Clustering by Left-Stochastic Matrix Factorization	Raman Arora et al.
12:10–1:40	Lunch Break			
	Spruce	MLJ Editorial Board Meeting		
1:40–3:20	A	3A Neural Networks and Statistical Methods Area chair: Thore Graepel	Minimum Probability Flow Learning	Jascha Sohl-Dickstein; Peter Battaglino; Michael DeWeese
			The Importance of Encoding Versus Training with Sparse Coding and Vector Quantization	Adam Coates; Andrew Ng
			Learning Recurrent Neural Networks with Hessian-Free Optimization	James Martens; Ilya Sutskever
			On Random Weights Unsupervised Feature Learning	Andrew Saxe et al.
	I	3I Latent-Variable Models Area chair: Alexander Ihler	On the Integration of Topic Modeling and Dictionary Learning	Lingbo Li; Mingyuan Zhou; Guillermo Sapiro; Lawrence Carin
			Beam Search based MAP Estimates for the Indian Buffet Process	Piyush Rai; Hal Daume III
			Tree-Structured Infinite Sparse Factor Model	X. Zhang; D. Dunson; L. Carin
			Sparse Additive Generative Models of Text	Jacob Eisenstein; Amr Ahmed; Eric Xing
	E	3E Large-Scale Learning Area chair: Rich Caruana	Hashing with Graphs	Wei Liu; Jun Wang; Sanjiv Kumar; Shih-Fu Chang
			Large Scale Text Classification using Semi-supervised Multinomial Naive Bayes	Jiang Su; Jelber Sayyad Shirab; Stan Matwin
			Parallel Coordinate Descent for L1-Regularized Loss Minimization	Joseph Bradley; Aapo Kyrola; Daniel Bickson; Carlos Guestrin
			OptiML: An Implicitly Parallel Domain-Specific Language for Machine Learning	Arvind Sujeeth et al.

	F	3F Learning Theory Area chair: Sally Goldman	On the Necessity of Irrelevant Variables	Dave Helmbold; Phil Long	
			A PAC-Bayes Sample-compression Approach to Kernel Methods	Pascal Germain; Alexandre Lacoste; Francois Laviolette; Mario Marchand; Sara Shanian	
			Simultaneous Learning and Covering with Adversarial Noise	Andrew Guillory; Jeff Bilmes	
			Risk-Based Generalizations of f-divergences	Dario García-García; Ulrike von Luxburg; Raúl Santos-Rodríguez	
	G	3G Feature Selection, Dimensionality Reduction Area chair: Corinna Cortes	Eigenvalue Sensitive Feature Selection	Yi Jiang; Jiangtao Ren	
			Cauchy Graph Embedding	Dijun Luo; Chris Ding; Feiping Nie; Heng Huang	
			Tree preserving embedding	Albert Shieh; Tatsunori Hashimoto; Edo Airolidi	
			Stochastic Low-Rank Kernel Learning for Regression	Pierre Machart; Thomas Peel; Sandrine Anthoine; Liva Ralaivola; Hervé Glotin,	
3:20–3:50	Coffee Break				
3:50–5:30	A	4A Invited Cross-Conference Track Area chair: Dragos Margineantu	Debt Collections Using Constrained Reinforcement Learning	Naoki Abe et al.	
			Modeling Mutual Context of Object and Human Pose in Human-Object Interaction Activities	Bangpeng Yao; Aditya Khosla; Li Fei-Fei	
			Efficient Planning under Uncertainty for a Target-Tracking Micro-Aerial Vehicle in Urban Environments	Abraham Bachrach; Ruijie He; Nicholas Roy	
			Gesture-Based Human-Robot Jazz Improvisation	Gil Weinberg	
	I	4I Neural Networks and Deep Learning Area chair: Eric Xing	Learning attentional policies for tracking and recognition in video with deep networks	Loris Bazzani; Nando Freitas; Hugo Larochelle; Vittorio Murino; Jo-Anne Ting	
			Learning Deep Energy Models	Jiquan Ngiam; Zhenghao Chen; Pang Wei Koh; Andrew Ng	
			Unsupervised Models of Images by Spike-and-Slab RBMs	Aaron Courville; James Bergstra; Yoshua Bengio	
			On Autoencoders and Score Matching for Energy Based Models	Kevin Swersky; Marc'Aurelio Ranzato; David Buchman; Benjamin Marlin; Nando Freitas	
	E	4E Latent-Variable Models Area chair: Katherine Heller	Topic Modeling with Nonparametric Markov Tree	Haojun Chen; David Dunson; Lawrence Carin	
			Infinite SVM: a Dirichlet Process Mixture of Large-margin Kernel Machines	Jun Zhu; Ning Chen; Eric Xing	
			Piecewise Bounds for Estimating Bernoulli-Logistic Latent Gaussian Models	Benjamin Marlin; Mohammad Khan; Kevin Murphy,	
			A Spectral Algorithm for Latent Tree Graphical Models	Ankur Parikh; Le Song; Eric Xing	
	F	4F Active and Online Learning Area chair: Burr Settles	Speeding-Up Hoeffding-Based Regression Trees With Options	Elena Ikononovska; João Gama; Bernard Zenko; Saso Dzeroski	
			Adaptively Learning the Crowd Kernel	Omer Tamuz et al.	
			Bundle Selling by Online Estimation of Valuation Functions	Daniel Vainsencher; Ofer Dekel; Shie Mannor	
			Active Learning from Crowds	Yan Yan; Romer Rosales; Glenn Fung; Jennifer Dy	
	G	4G Ensemble Methods Area chair: Chris Burges	Efficient Rule Ensemble Learning using Hierarchical Kernels	Pratik Jawanpuria; Saketha Nath Jagarlapudi; G. Ramakrishnan	
			Boosting on a Budget: Sampling for Feature-Efficient Prediction	Lev Reyzin	
			Multiclass Boosting with Hinge Loss based on Output Coding	Tianshi Gao; Daphne Koller	
			Generalized Boosting Algorithms for Convex Optimization	Alexander Grubb; Drew Bagnell	
	5:30–6:00	A	Test-of-Time Chair: Tom Dietterich	Conditional Random Fields: Probabilistic Models for Segmenting and Labeling Sequence Data	John D. Lafferty; Andrew McCallum; Fernando C. N. Pereira
	6:00–10:00	Evergreen Ballroom	Poster Session	Papers from Sessions 2A-7E	

Thursday, June 30, 2011

Time	Room	Session	Presentation/Event	Authors/Presenters	
8:30-9:00	A	Best Paper Chairs: Lise Getoor & Tobias Scheffer	Computational Rationalization: The Inverse Equilibrium Problem	Kevin Waugh; Brian Ziebart; Drew Bagnell	
9:00-10:00	A	Keynote Chair: Lise Getoor	Evolutionary Dynamics of Competition and Cooperation	Martin Nowak	
10:00-10:30	Coffee Break				
10:30-12:10	A	7A Robotics and Reinforcement Learning Area chair: Joelle Pineau	Conjugate Markov Decision Processes	Philip Thomas; Andrew Barto	
			Approximate Dynamic Programming for Storage Problems	Lauren Hannah; David Dunson	
			Apprenticeship Learning About Multiple Intentions	Monica Babes; Vukosi Marivate; Michael Littman; Kaushik Subramanian	
			Classification-based Policy Iteration with a Critic	Victor Gabillon; Alessandro Lazaric; Mohammad Ghavamzadeh; Bruno Scherrer	
	I	7I Transfer Learning Area chair: Kilian Weinberger	A Graph-based Framework for Multi-Task Multi-View Learning	Jingrui He; Rick Lawrence	
			Learning from Multiple Outlooks	Maayan Harel; Shie Mannor	
			Learning with Whom to Share in Multi-task Feature Learning	Zhuoliang Kang; Kristen Grauman; Fei Sha	
			Hierarchical Classification via Orthogonal Transfer	Lin Xiao; Dengyong Zhou; Mingrui Wu	
	E	7E Kernel Methods Area chair: Olivier Chapelle	BCDNPCL: Scalable Non-Parametric Kernel Learning Using Block Coordinate Descent	En-Liang Hu; Bo Wang; SongCan Chen	
			Ultra-Fast Optimization Algorithm for Sparse Multi Kernel Learning	Francesco Orabona; Luo Jie	
			Fast Global Alignment Kernels	Marco Cuturi	
			Mapping kernels for trees	Kilho Shin; Marco Cuturi; Tetsuji Kuboyama	
	F	7F Optimization Area chair: Jeff Bilmes	Fast Newton-type Methods for Total Variation Regularization	Ivaro Barbero; Suvrit Sra	
			The Constrained Weight Space SVM: Learning with Ranked Features	Kevin Small; Byron Wallace; Carla Brodley; Thomas Trikalinos	
			Size-constrained Submodular Minimization through Minimum Norm Base	Kiyohito Nagano; Yoshinobu Kawahara; Kazuyuki Aihara	
			Manifold Identification of Dual Averaging Methods for Regularized Stochastic Online Learning	Sangkyun Lee; Stephen Wright	
	G	7G Learning Theory Area chair: Nicolo Cesa-Bianchi	Multiple Instance Learning with Manifold Bags	Boris Babenko; Nakul Verma; Piotr Dollar; Serge Belongie	
			Minimax Learning Rates for Bipartite Ranking and Plug-in Rules	Sylvain Robbiano; Stéphan Cléménçon	
			From PAC-Bayes Bounds to Quadratic Programs for Majority Votes	Jean-Francois Roy; Francois Laviolette; Mario Marchand	
	12:10-1:40	Maple	Women in Machine Learning (WiML) Luncheon (registration required; see website)		
	1:40-3:20	A	8A Invited Cross-Conference Session Area chair: Prem Melville	High resolution models of transcription factor-DNA affinities improve in vitro and in vivo binding predictions	All women working on machine learning are invited
Suggesting Friends Using the Implicit Social Graph				Christina Leslie	
Relevance and ranking in online dating systems				Maayan Roth; Tzvika Barenholz; Assaf Ben-David; David Deutscher; Guy Flysher; Avinatan Hassidim; Ilan Horn; Ari Leichtberg; Naty Leiser; Yossi Matias; Ron Merom	
We Just Clicked - Conversational Features of Social Bonding in Speed Dates				Fernando Diaz; Donald Metzler; Sihem Amer-Yahia	

	I	8I Neural Networks and Deep Learning Area chair: Yoshua Bengio	Enhanced Gradient and Adaptive Learning Rate for Training Restricted Boltzmann Machines	Rajesh Ranganath; Dan Jurafsky; Dan McFarland
			On optimization methods for deep learning	KyungHyun Cho; Tapani Raiko; Alexander Ilin
			The Hierarchical Beta Process for Convolutional Factor Analysis and Deep Learning	Quoc Le; Jiquan Ngiam; Adam Coates; Abhik Lahiri; Bobby Prochnow; Andrew Ng
			Multimodal Deep Learning	Bo Chen; Gungor Polatkan; Guillermo Sapiro; David Dunson; Lawrence Carin
	E	8E Reinforcement Learning Area chair: Prasad Tadepalli	Mean-Variance Optimization in Markov Decision Processes	Jiquan Ngiam; Aditya Khosla; Mingyu Kim; Juhan Nam; Honglak Lee; Andrew Ng
			Incremental Basis Construction from Temporal Difference Error	Shie Mannor; John Tsitsiklis
			Variational Inference for Policy Search in changing situations	Yi Sun; Faustino Gomez; Mark Ring; Jürgen Schmidhuber
			Finite-Sample Analysis of Lasso-TD	Gerhard Neumann
	F	8F Bayesian Inference and Probabilistic Models Area chair: Andrew Ng	Estimating the Bayes Point Using Linear Knapsack Problems	Mohammad Ghavamzadeh; Alessandro Lazaric; Remi Munos; Matthew Hoffman
			Message Passing Algorithms for the Dirichlet Diffusion Tree	Brian Potetz
			Variational Inference for Stick-Breaking Beta Process Priors	David Knowles; Jurgan Van Gael; Zoubin Ghahramani
			Infinite Dynamic Bayesian Networks	John Paisley; Lawrence Carin; David Blei
	G	8G Supervised Learning Area chair: Alex Niculescu-Mizil	Multi-Label Classification on Tree- and DAG-Structured Hierarchies	Finale Doshi; David Wingate; Josh Tenenbaum; Nicholas Roy
			Surrogate losses and regret bounds for cost-sensitive classification with example-dependent costs	Wei Bi; James Kwok
			Support Vector Machines as Probabilistic Models	Clayton Scott
			Locally Linear Support Vector Machines	Vojtech Franc; Alexander Zien; Bernhard Schölkopf
3:20–3:50	Coffee Break			
3:50–4:40	A	9A Social Networks Area chair: Alice Zheng	Uncovering the Temporal Dynamics of Diffusion Networks	Manuel Gomez Rodriguez; David Balduzzi; Bernhard Schölkopf
			Dynamic Egocentric Models for Citation Networks	Duy Vu; Arthur Asuncion; David Hunter; Padhraic Smyth
	I	9I Evaluation Metrics Area chair: Tomas Singliar	Brier Curves: a New Cost-Based Visualisation of Classifier Performance	Jose Hernandez-Orallo; Peter Flach; César Ferri
			A Coherent Interpretation of AUC as a Measure of Aggregated Classification Performance	Peter Flach; Jose Hernandez-Orallo; César Ferri
	E	9E Statistical relational learning Area chair: Pedro Domingos	Relational Active Learning for Joint Collective Classification Models	Ankit Kuwadekar; Jennifer Neville
			A Three-Way Model for Collective Learning on Multi-Relational Data	Maximilian Nickel; Volker Tresp; Hans-Peter Kriegel
	F	9F Outlier Detection Area chair: Naoki Abe	Learning Multi-View Neighborhood Preserving Projections	Novi Quadrianto; Christoph Lampert
			On the Robustness of Kernel Density M-Estimators	JooSeuk Kim; Clayton Scott
	G	9G Time Series Area chair: Naoki Abe	Time Series Clustering: Complex is Simpler!	Lei Li; B. Aditya Prakash
			Learning Discriminative Fisher Kernels	Laurens Van der Maaten
4:50	Evergreen North Foyer / First Floor	Banquet buses depart for the Museum of Flight		
6:30–10:00	Museum of Flight	ICML Banquet sponsored by Amazon.com		

Friday, July 1, 2011

Time	Room	Session	Presentation/Event	Authors/Presenters	
8:30–9:30	A	Keynote	Machine Learning in Google Goggles	Hatmut Neven	
9:30–10:00	Coffee Break				
10:00–12:10	A	11A Graphical Models and Bayesian Inference Area chair: Pradeep Ravikumar	Variational Heteroscedastic Gaussian Process Regression	Miguel Lazaro-Gredilla; Michalis Titsias	
			Predicting Legislative Roll Calls from Text	Sean Gerrish; David Blei	
			Bounding the Partition Function using Holder's Inequality	Qiang Liu; Alexander Ihler	
			On Bayesian PCA: Automatic Dimensionality Selection and Analytic Solution	Shinichi Nakajima; Masashi Sugiyama; Derin Babacan	
				Bayesian CCA via Group Sparsity	Seppo Virtanen; Arto Klami; Samuel Kaski
	I	11I Sparsity and Compressed Sensing Area chair: Nati Srebro	Efficient Sparse Modeling with Automatic Feature Grouping	Wenliang Zhong; James Kwok	
			Robust Matrix Completion and Corrupted Columns	Yudong Chen; Huan Xu; Constantine Caramanis; Sujay Sanghavi	
			Clustering Partially Observed Graphs via Convex Optimization	Ali Jalali; Yudong Chen; Sujay Sanghavi; Huan Xu	
			Noisy matrix decomposition via convex relaxation: Optimal rates in high dimensions	Alekh Agarwal; Sahand Negahban; Martin Wainwright	
			Submodular meets Spectral: Greedy Algorithms for Subset Selection, Sparse Approximation and Dictionary Selection	Abhimanyu Das; David Kempe	
	E	11E Clustering Area chair: Jennifer Neville	On Information-Maximization Clustering: Tuning Parameter Selection and Analytic Solution	Masashi Sugiyama; Makoto Yamada; Manabu Kimura; Hiroataka Hachiya	
			Pruning nearest neighbor cluster trees	Samory Kpotufe; Ulrike von Luxburg	
			A Co-training Approach for Multi-view Spectral Clustering	Abhishek Kumar; Hal Daume III	
			Clusterpath: an Algorithm for Clustering using Convex Fusion Penalties	Toby Hocking; Jean-Philippe Vert; Francis Bach; Armand Joulin	
			A Unified Probabilistic Model for Global and Local Unsupervised Feature Selection	Yue Guan; Jennifer Dy; Michael Jordan	
	F	11F Game Theory and Planning and Control Area chair: Shie Manor	Integrating Partial Model Knowledge in Model Free RL Algorithms	Aviv Tamar; Dotan Di Castro; Ron Meir	
			Task Space Retrieval Using Inverse Feedback Control	Nikolay Jetchev; Marc Toussaint	
			PILCO: A Model-Based and Data-Efficient Approach to Policy Search	Marc Deisenroth; Carl Rasmussen	
			Approximating Correlated Equilibria using Relaxations on the Marginal Polytope	Hetunandan Kamisetty; Eric Xing; Christopher Langmead	
				Generalized Value Functions for Large Action Sets	Jason Pazis; Ron Parr
	G	11G Semi-Supervised Learning Area chair: William Cohen	Vector-valued Manifold Regularization	Ha Quang Minh; Vikas Sindhwani	
			Semi-supervised Penalized Output Kernel Regression for Link Prediction	Céline Brouard; Florence D'Alche-Buc; Marie Szafranski	
			Access to Unlabeled Data can Speed up Prediction Time	Ruth Urner; Shai Shalev-Shwartz; Shai Ben-David	
			Automatic Feature Decomposition for Single View Co-training	Minmin Chen; Kilian Weinberger; Yixin Chen	
Towards Making Unlabeled Data Never Hurt			Yu-Feng Li; Zhi-Hua Zhou		
12:10–1:40	Lunch Break				
	Spruce	IMLS Board Meeting			

1:40–3:45	A	12A Kernel Methods and Optimization Area chair: Thorsten Joachims	Learning Output Kernels with Block Coordinate Descent	Francesco Dinuzzo; Cheng Soon Ong; Peter Gehler; Gianluigi Pillonetto
			Implementing regularization implicitly via approximate eigenvector computation	Michael Mahoney; Lorenzo Orecchia
			Adaptive Kernel Approximation for Large-Scale Non-Linear SVM Prediction	Michele Cossalter; Rong Yan; Lu Zheng
			Suboptimal Solution Path Algorithm for Support Vector Machine	Masayuki Karasuyama; Ichiro Takeuchi
			Functional Regularized Least Squares Classification with Operator-valued Kernels	Hachem Kadri; Asma Rabaoui; Philippe Preux; Emmanuel Duflos; Alain Rakotomamonjy
	I	12I Neural Networks and NLP Area chair: Hal Daume III	Parsing Natural Scenes and Natural Language with Recursive Neural Networks	Richard Socher; Cliff Chiung-Yu Lin; Andrew Ng; Chris Manning
			Domain Adaptation for Large-Scale Sentiment Classification: A Deep Learning Approach	Xavier Glorot; Antoine Bordes; Yoshua Bengio
			Large-Scale Learning of Embeddings with Reconstruction Sampling	Yann Dauphin; Xavier Glorot; Yoshua Bengio
			Generating Text with Recurrent Neural Networks	Ilya Sutskever; James Martens; Geoffrey Hinton
			Contractive Auto-Encoders: Explicit Invariance During Feature Extraction	Salah Rifai; Pascal Vincent; Xavier Muller; Xavier Glorot; Yoshua Bengio
	E	12E Probabilistic Models & MCMC Area chair: Ruslan Salakhutdinov	Probabilistic Matrix Addition	Amrudin Agovic; Arindam Banerjee; Snigdhasu Chatterje
			SampleRank: Training Factor Graphs with Atomic Gradients	Michael Wick; Khashayar Rohanimanesh; Kedar Bellare; Aron Culotta; Andrew McCallum
			A New Bayesian Rating System for Team Competitions	Sergey Nikolenko; Alexander Sirotkin
			Bayesian Learning via Stochastic Gradient Langevin Dynamics	Max Welling; Yee Whye Teh
			ABC-EP: Expectation Propagation for Likelihood-free Bayesian Computation	Simon Barthelmé; Nicolas Chopin
	F	12F Online Learning Area chair: Claudio Gentile	Online AUC Maximization	Peilin Zhao; Steven Hoi; Rong Jin; Tianbao Yang
			Online Submodular Minimization for Combinatorial Structures	Stefanie Jegelka; Jeff Bilmes
			Better Algorithms for Selective Sampling	Francesco Orabona; Nicolò Cesa-Bianchi
			Learning Linear Functions with Quadratic and Linear Multiplicative Updates	Tom Bylander
			Optimal Distributed Online Prediction	Ofer Dekel; Ran Gilad-Bachrach; Ohad Shamir; Lin Xiao
	G	12G Ranking and Information Retrieval Area chair: Mikhail Bilenko	Learning Mallows Models with Pairwise Preferences	Tyler Lu; Craig Boutilier
			Preserving Personalized Pagerank in Subgraphs	Andrea Vattani; Deepayan Chakrabarti; Maxim Gurevich
			Learning Scoring Functions with Order-Preserving Losses and Standardized Supervision	David Buffoni; Clément Calauzenes; Patrick Gallinari; Nicolas Usunier
			Bipartite Ranking through Minimization of Univariate Loss	Wojciech Kotłowski; Krzysztof Dembczynski; Eyke Huellermeier
			k-DPPs: Fixed-Size Determinantal Point Processes	Alex Kulesza; Ben Taskar
3:45–4:15	Coffee Break			
4:15–5:15	A	Keynote Chair: Ray Mooney	Building Watson: An Overview of the DeepQA Project	David Ferrucci
5:15–6:15	A	ICML Business Meeting all ICML participants are invited to attend		Raymond Mooney
6:00–10:00	Evergreen	Poster Session	Papers from Sessions 8A-12E	

Saturday, July 2, 2011 - ICML Workshops

Workshop room numbers and configuration.

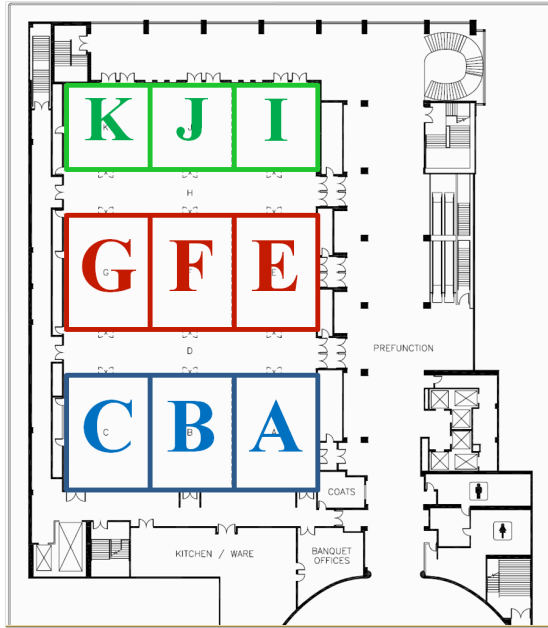

Please see conference website for the workshop schedules of events.

Room	Workshop Title	Organizers
A	Unsupervised and Transfer Learning	Isabelle Guyon, Daniel Silver
B	New Developments in Imitation Learning	Abdeslam Boularias, Brian Ziebart, Jan Peters
C	Online Trading of Exploration and Exploitation 2	Louis Dorard, John Shawe-Taylor, Suzanne Weller, Dorota Glowacka, Zakria Hussain
E	Structured Sparsity: Learning and Inference	Francis Bach, Mladen Kolar, Han Liu, Guillaume Obozinski, Eric P. Xing
F	Combining Strategies for Reducing the Label Cost	Hal Daume III, Piyush Rai, Burr Settles, Jerry Zhu
G	Machine Learning for Global Challenges	Arindam Banerjee, Rayid Ghani, Claire Monteleoni, Vikas Sindhwani
I	Learning Architectures, Representations, and Optimization for Speech & Visual Information Processing	Li Deng, Honglak Lee, Kai Yu
J	Planning and Acting with Uncertain Models	Finale Doshi, David Wingate
K	Learning from Unstructured Clinical Text	Faisal Farooq, Noemie Elhadad, Balaji Krishnapuram, R. Bharat Rao, Zeeshan Syed, Ozlem Uzuner, Shipeng Yu

Useful Local Information

To make your stay in Bellevue as hassle-free as possible, we compiled some useful information for you here.

Local Contacts

Your local chairs and organizers are

Dragos Margineantu – dragos@icml-2011.org

Tomas Singliar – tomas@icml-2011.org

Internet Connection

Wireless internet is available in the conference area free of charge for conference registrants. Please use the network *Hyatt-MEETING* and passcode *ICML2011*. The Hyatt charges a daily fee for wireless internet access in the guest rooms, but wired in-room internet access is free for participants who booked the ICML rate.

Getting Around with a Map

In Bellevue and adjacent cities, streets are mostly numbered and there's a system to it. The road system is roughly an axis-aligned rectangular grid. The streets running North-South are named *Avenues* (e.g., 108th Ave SE), those running East-West are named *Streets* (e.g., NE 8th St). '*Ways*' (*Wy*), '*Roads*' (*Rd*), '*Drives*' (*Dr*), and '*Places*' (*Pl*) may run in any direction. Bellevue Way is the name of 104th Ave SE.

There is a "directional" attached to Street and Avenue names: in Bellevue you will see SouthEast (SE), and NorthEast (NE) depending on whether you are south or north of Main St. In Bellevue you will always be east of the reference point, which is in Seattle. Seattle itself is a bit more complicated (http://en.wikipedia.org/wiki/Street_layout_of_Seattle).

Important Locations

Bellevue Transit Center (the bus terminal)

Buses to/from the airport, downtown Seattle, the University of Washington, downtown Kirkland:

- 10850 NE 6th Street, Bellevue, WA (from the Hyatt, just walk three blocks East to 108th Ave SE and then one block South to the transit center)
- Route 550 – to/from downtown Seattle,
- Route 556 – to the University of Washington District
- Route 560 – to/from the Airport
- Route 280 – late night back from Seattle to Bellevue
- Route 234 – to/from Kirkland

Post Office

1171 Bellevue Way NE (two blocks north of the Hyatt)

Banks

There are several bank branches within 2 blocks of the Hyatt. The closest ones are

- (1) U.S. Bank, 10425 NE 8th St, (425) 635-0399
- (2) Chase, 10550 NE 8th St, (425) 590-4242
- (3) Bank of America, 10555 NE 8th St, (206) 358-5112
- (4) Bank of America, 10116 NE 8th St (inside QFC), 206-585-6430

Printing and Photocopying

FedEx Office (formerly Kinko's) has two locations in downtown Bellevue:

- (1) 40 Bellevue Way NE
- (2) 10635 NE 8th Street

Grocery Stores

Two excellent grocery stores, are located within 2–3 minutes of walking from the Hyatt:

QFC (one block West of the Hyatt): 10116 NE 8th Street

Safeway (two blocks South of the Hyatt): 300 Bellevue Way NE

Pharmacies

Bartell Drugs (one block West of the Hyatt, next to QFC): 10116 NE 8th Street, (425) 454-3111

Safeway (two blocks South of the Hyatt): 300 Bellevue Way NE, (425) 749-3885

Hospital / Emergency Room

Overlake Hospital Medical Center
1035 116th Avenue Northeast
Bellevue, WA 98004
Tel.: (425) 688-5000

Activities

Walking & Jogging

The **Bellevue Downtown Park** (two blocks south of the Hyatt) is a very pleasant place to walk or jog. In addition, all streets around the Bellevue Hyatt are safe for jogging or having a stroll at any time of the day or night.

The **Mercer Slough Park Nature Park** is the perfect place for a quiet walk in the wild, but in the meantime, very close to downtown Bellevue. The Mercer Slough offers more than 7 miles of trails that wind through 320 acres of wildlife habitat and freshwater wetlands. You can reach get to the park by walking South (roughly a 20-30 minute walk) on Bellevue Way. If you drive there, parking space is available.

Night Life

In Bellevue: Bellevue is pretty quiet (and very safe!) at night. We recommend the "Parlor Billiards & Spirits" and the "Lucky Strike Lanes" bowling alley – both located in the Lincoln Square tower across NE 8th (skybridge) from the Hyatt.

In Kirkland: downtown Kirkland is a vibrant place especially on warm Summer evenings and on weekends.

In Seattle: the places to be at night are (1) Belltown (along 2nd and 3rd Sts., north of downtown Seattle) and (2) the University District (West of the University of Washington campus).

Shopping

Bellevue Square Mall (just across the street from the Hyatt)
The Bravern (if you are into expensive boutiques)
Downtown Seattle

On the Water

Cruises on Lake Washington (from downtown Kirkland), and
Cruises on Elliott Bay (from Seattle's waterfront)

Check out **www.argosycruises.com**

Boat rentals (from Bellevue and Kirkland)

Yarrow Bay Marina

5207 Lake Washington Blvd. NE, Kirkland
(425) 822-6066

Cascade Canoe & Kayak Center

3519 108th Ave SE, Bellevue
(425) 430-0111, (888) 485-2925

Museums and Tours

In Bellevue:

- The Bellevue Art Museum (one block South of the Hyatt on Bellevue Way)
- The Museum of Doll Art (1116 108th Ave NE)

In Seattle:

- Seattle Arts Museum
- Pacific Science Center
- Experience Music Project
- The Seattle Aquarium
- The Museum of Flight - the location of our banquet, but during our banquet you will not be able to see the inside of the Concorde and the Boeing 707 Air Force One that are on display.
- The Seattle Underground tour. A very entertaining and informative experience in which you'll learn about the first few decades of the city of Seattle. Highly recommended especially for a rainy weekend day.

In Everett (about 30 miles North of Bellevue):

- Boeing's Tour Center. Tour the final assembly of Boeing's twin-aisle airplanes: the 747, 767, 777, and 787. A unique experience. The Tour is open only on weekdays.

Experiencing our Mountains

Bellevue and Seattle are located between two mountain ranges: the Coast range (to the West) and the Cascades (to the East). The mountains most quickly accessible by car are along the Interstate-90 (about 30 miles East of Bellevue).

Three National Parks are within 1.5-3 hours of driving:

- (1) Mount Rainier National Park (1.5 hrs. drive South)
- (2) North Cascades National Park (2.5 hrs drive North)
- (3) Olympic National Park (ferry ride + 2hrs of driving)

You can find descriptions of most local hikes at www.wta.org.

Talk to Dragos (dragos@icml-2011.org) about planning a leisurely trip in the mountains or to Tomas (tomas@icml-2011.org) for planning a day (or more) of hiking in the mountains.

Your Morning, Afternoon, Evening, or Midnight Coffee

Coffee is part of the culture in the Seattle area. Even if you are not an avid coffee drinker, try to enjoy a coffee while attending ICML.

Aside of the numerous **Starbucks** and **Tully's** coffee shops located throughout the Puget Sound, we highly recommend **Vivace** (espressovivace.com) and their three Seattle locations:

- (1) Espresso Vivace Alley 24, 227 Yale Ave N, Seattle, WA
- (2) Espresso Vivace Sidewalk Bar, 321 Broadway Avenue East, Seattle, WA
- (3) Vivace Espresso Bar at Brix, 532 Broadway Ave East, Seattle, WA

In Bellevue, we recommend **Café Ladro** (3 blocks East of the Hyatt):

Café Ladro, 333 108th Ave NE, Tower 333 Building (betw 10th St & 2nd Pl).

Dining

Breakfast

The **Twisted Cork** (first floor, West side) is Hyatt's breakfast restaurant. It is open 6:30am-10:30am on weekdays and 6:30am-11:30am on weekends (Saturday and Sunday).

Your fast breakfast options are:

- (1) **Needs Deli | Mercantile**, on the second floor of the hotel;
- (2) **Tully's Coffee**, in the lobby area of the hotel;
- (3) **Wendy's**, behind the hotel on Bellevue Way.

The map on page 20 shows dining options in the immediate vicinity of the Hyatt.

Lunch and Dinner

All the restaurants listed below are within walking distance from the Hyatt and are highly recommended by your local organizers. The ratings refer to their biased assessment of a mixture of the quality of food and the atmosphere:

*** = memorable ** = outstanding * = excellent
\$ = \$1-\$15 \$\$ = \$16-\$35 \$\$\$ = \$36-\$60 \$\$\$\$ = \$60+ per person for dinner

Cuisine	Restaurant	Price	Local's Rating	Locals' comments / Address
Pacific Northwest/ Eclectic	Bis on Main	\$\$\$	**	This restaurant serves a wonderful mix of dishes ranging from vegan to seafood to beef, in a very pleasant ambiance. Good wine list and cocktails. 10213 Main St., open for dinner daily and for lunch on weekdays.
	Purple Café & Wine Bar	\$\$	**	A casual place for delicious dishes and great wines. 430 106th Ave. NE (@ 4th St.). Open for lunch and dinner daily.
	Joey	\$\$	*	Across from the Hyatt lobby, this is a good option for our short lunch breaks.
Barbecue	Dixie's BBQ	\$	**	Delicious barbecued pork and beef sandwiches and dishes in a former car repair garage. Their sauce "The Man" is probably the hottest sauce you've ever experienced. About 25 minutes of walking. 11522 Northup Way, open 11am-4:30pm, closed on Sundays.
	3-Pigs Bar B-Q	\$-\$\$	*	Tasty and inexpensive Texas-style and Kansas City-style barbecue. 1048 116th Ave. NE, 11am-8pm, closed on Sundays.
Chinese	Bamboo Garden	\$\$	**	An inexpensive Szechuan restaurant. The setting and atmosphere are not something to brag about. 202 106th Pl. NE (@ 2nd St.), open daily for lunch and dinner.
	Melting Pot	\$\$\$	**	Fondue style dishes and desserts. Each custom-made table has a heater in the middle. Very attentive service. Highly recommended for groups of 3 or more people. 302 108th Ave. NE, open daily just for dinner.
Italian	Andiamo	\$\$\$	**	This is an elegant and small restaurant serving delicious Italian dishes. 938 110th Ave NE, open daily for dinner and open for lunch on weekdays.
	Cantinetta	\$\$	**	Tuscan food plus home-made pasta served in a setting that tries to evoke a Tuscan farmhouse. 10038 Main St., open daily for dinner, closed on Mondays.
	Pasta & Co	\$\$	**	An Italian food market and deli. A good option for a fast meal. 10218 NE 8th St.

Cuisine	Restaurant	Price	Local's Rating	Locals' comments / Address
Japanese / Sushi	Sushi Maru	\$\$	***	Several Sushi restaurants have opened over the last two years in the downtown area of Bellevue. This one is the best. They'll do any roll to satisfy your taste. 205 105th Ave NE, open for lunch and dinner daily.
	Flo	\$\$\$	**	1150 106th Ave. NE (@ 12th St.), open daily for dinner and on weekdays for lunch.
	I Love Sushi	\$\$	***	The best Sushi place around. It is within 10 minutes of walking East on NE 8 th from the Hyatt. 11818 NE 8th St. (@ 118th Ave.)
Lebanese / Mediterranean	Mediterranean Kitchen	\$\$	***	This restaurant serves some of the tastiest Lebanese and middle-Eastern dishes on Earth. The garlic and spices are nicely combined but are not overwhelming. The dishes are large, so go there if you're hungry. Lunch or dinner. Great efficient service in a cozy atmosphere. 103 Bellevue Way NE (@ 1st St.), 11am-2:30pm, 4:30pm-9:30pm, Closed on Sundays.
	Ooba's Mexican Grill	\$	**	Mexican cuisine is not the strongest feat of the Seattle-area eateries. This place is the exception. Fast, informal Mexican lunches. Great salsas. 555 108th Ave. NE, open only for lunch Mon-Fri.
Pizza	Barrio	\$\$	*	A casual Mexican and Southwestern restaurant. Next to Purple (the same owners). 10650 NE 4th St., open for lunch an dinner daily.
	MOD Pizza	\$	**	MOD stands for "Made On Demand". This should be one of your top dining options for a very fast lunch or dinner. All their pizzas cost \$6.28 and they are made in front of you, and are delicious. 317 Bellevue Way NE
	Pagliacci Pizza	\$-\$	**	Good pizza, within a two-minute walk from the Hyatt. 563 Bellevue Sq. (on 8th St.) open daily.
Pan-Asian	Wild Ginger	\$\$-\$\$\$	**	Creative Southeast Asian cuisine. A great culinary experience. Open daily for lunch and dinner. Brunch on Weekends. In The Bravern, 11020 NE 6th St.

Cuisine	Restaurant	Price	Local's Rating	Locals' comments / Address
Seafood	Seastar Restaurant & Raw Bar	\$\$\$	***	Your best choice for seafood in Bellevue. Somewhat more formal and more expensive than the other Eastside seafood restaurants. 205 108th Ave. NE, open for lunch, dinner, and happy hour on weekdays. Just dinner on weekends.
	McCormick & Schmick's	\$\$-\$\$\$	*	Good menu choices across NE 8 th St from the Hyatt. Seafood, steaks, and pasta. 700 Bellevue Way NE, open daily for lunch and dinner.
	El Gaucho	\$\$\$-\$\$\$\$	***	The best steakhouse in Bellevue. Dinner is a great experience. Expensive. 450 108th Ave. NE, open Mon-Sat for lunch and dinner, and just for dinner Sundays.
Steakhouse	Daniel's Broiler	\$\$\$-\$\$\$\$	**	The restaurant with the best views in Bellevue is an elevator ride away from ICML. Try their bone-in tenderloin, if they serve it. Lunch is not that expensive. Elevator ride from 2 nd floor to the 21 st floor. Open on daily for dinner; on weekdays for lunch.
	John Howie Steak	\$\$\$-\$\$\$\$	*	Good steaks in a more formal setting. 11111 NE 8 th St. (in The Bravern), open weekdays for lunch and dinner and on weekends just for dinner.
	Ruth's Chris Steakhouse	\$\$\$-\$\$\$\$	***	Excellent steaks and great service within a two-minute walk from the Hyatt. 565 Bellevue Sq. (on 8th St.). Open daily for lunch and dinner.
Taiwanese	Facing East	\$-\$\$	**	Outstanding Taiwanese food. It tends to get busy for lunch. 1075 Bellevue Way NE. Open daily for lunch and dinner.
	Chantane	\$	***	The best Thai food in Bellevue. Many choices. Very creative. 601 108th Ave. NE. Open daily for lunch and dinner.
Thai	King and I	\$	**	Good Thai food. 10509 Main Street. Open daily for lunch and dinner.

The restaurants listed below are located in the greater Seattle area and are not within walking distance from the Bellevue Hyatt, but we believe that these places are worthwhile a car or taxi ride for a memorable dining experience (these places all get *** from us).

Restaurant	Price	Address / Hours	Locals' comments
Rover's	\$\$\$\$	2808 E. Madison St., Seattle, WA. Open for Dinner. Friday open for lunch.	French Cuisine Dragos believes that this is the best restaurant in the Seattle area. Fresh ingredients from the market, creative cuisine. It is very expensive though.
Luc	\$\$	2800 E. Madison St., Seattle, WA. Open daily. Sunday brunch.	American & French Cuisine The owner/chef of Rover's decided to open an informal bistro next door.
Harvest Vine	\$\$-\$\$\$	2701 E. Madison St., Seattle, WA. Open daily for dinner. Sat & Sun for lunch.	Basque Cuisine / Tapas Across the street from Luc. Great atmosphere. Wonderful and not so expensive food. & wines.
The Herbfarm	\$\$\$\$	14590 NE 145th St., Woodinville, WA. Open Thu-Sun for dinner.	Pacific Northwest cuisine. Locally grown food. Dinner is a 5-10pm experience that starts with a tour of the farm. Seasonal menus. Very expensive.
Café Juanita	\$\$\$-\$\$\$\$	9702 NE 120th Pl., Kirkland, WA. Open Tue- Sun for dinner.	Northern Italian cuisine. The best restaurant on the Eastside. A great relaxed atmosphere. Fresh & organic ingredients. It will be truly memorable.
Matt's in the Market	\$\$	94 Pike St # 32 Seattle, WA. Lunch & dinner. Mon- Sat.	THE place to eat in Seattle's historic Pike Place Market. Fresh ingredients and great atmosphere. Very small (but it used to be less than half its current size) & cozy.
Spinasse	\$\$\$	1531 14th Ave., Seattle, WA. Open for dinner. Closed on Tuesdays.	Outstanding Piedmont cuisine plus handmade pasta.
Sitka & Spruce	\$\$\$	1531 Melrose Ave. E. (betw. Pike & Pine), Seattle, WA. Open for dinner. Closed on Tuesdays.	International Cuisine. A great small restaurant, tasty food crafted out of fresh ingredients.
Canlis	\$\$\$\$	2576 Aurora Ave. N. (Westlake Ave.) Seattle, WA. Open for dinner Mon- Sat.	French Cuisine Formal setting. Great views. The only restaurant in the Seattle area that requires men to wear a jacket.
Tilth	\$\$\$	1411 N. 45th St., Seattle, WA. Open daily for dinner. Sat & Sun brunch.	American Cuisine. Very creative.

Bakery Nouveau	\$\$	In West Seattle. 4737 California Ave. SW, Seattle, WA. 6am-7pm daily.	One of the greatest bakeries you have ever experienced. Even if your country is France or Belgium. Worthwhile the 30-minute drive, especially on a morning to enjoy their twice-baked almond croissants with a cup of coffee.
Top Gun	\$\$	12450 SE 38th St., Bellevue, WA. Open daily for lunch & dinner.	The best Dim Sum in the Puget Sound. In Bellevue, a 10 min. taxi ride from the Hyatt.
Szechuan Chef	\$-\$	15015 Main St #107, Bellevue, WA. Open daily for lunch & dinner.	The best Szechuan restaurant in the Puget Sound. It is located in Bellevue, within a 10 minute car/taxi ride from downtown. Worthwhile visiting for lunch. Inexpensive. In a strip mall.
Café Flora	\$\$-\$\$\$	2901 E. Madison St. Seattle, WA. Open daily for lunch & dinner.	One of the most creative vegan, vegetarian, and gluten-free restaurants.
Salty's on Alki	\$\$\$	In West Seattle. 1936 Harbor Avenue SW Seattle, WA. Daily lunch & dinner. Sat & Sun Brunch.	Seafood and American cuisine. The food is good but we recommend this restaurant for its views of downtown Seattle. You can have a memorable brunch there on Saturdays or on Sundays.
Sky City	\$\$\$-\$\$\$\$	Seattle Center. In the Space Needle. Open daily. Sunday brunch.	This is a revolving restaurant at the top of the Space Needle in Seattle. The food is good (much better than it used to be 3+ years ago). The views and the experience will be spectacular.
Red Mill Burger	\$	Two locations in Seattle: (1) 312 North 67th St, (2) 1613 W Dravus St. Closed on Mondays.	The best hamburgers you've ever had.

Maps

Hyatt Regency Bellevue

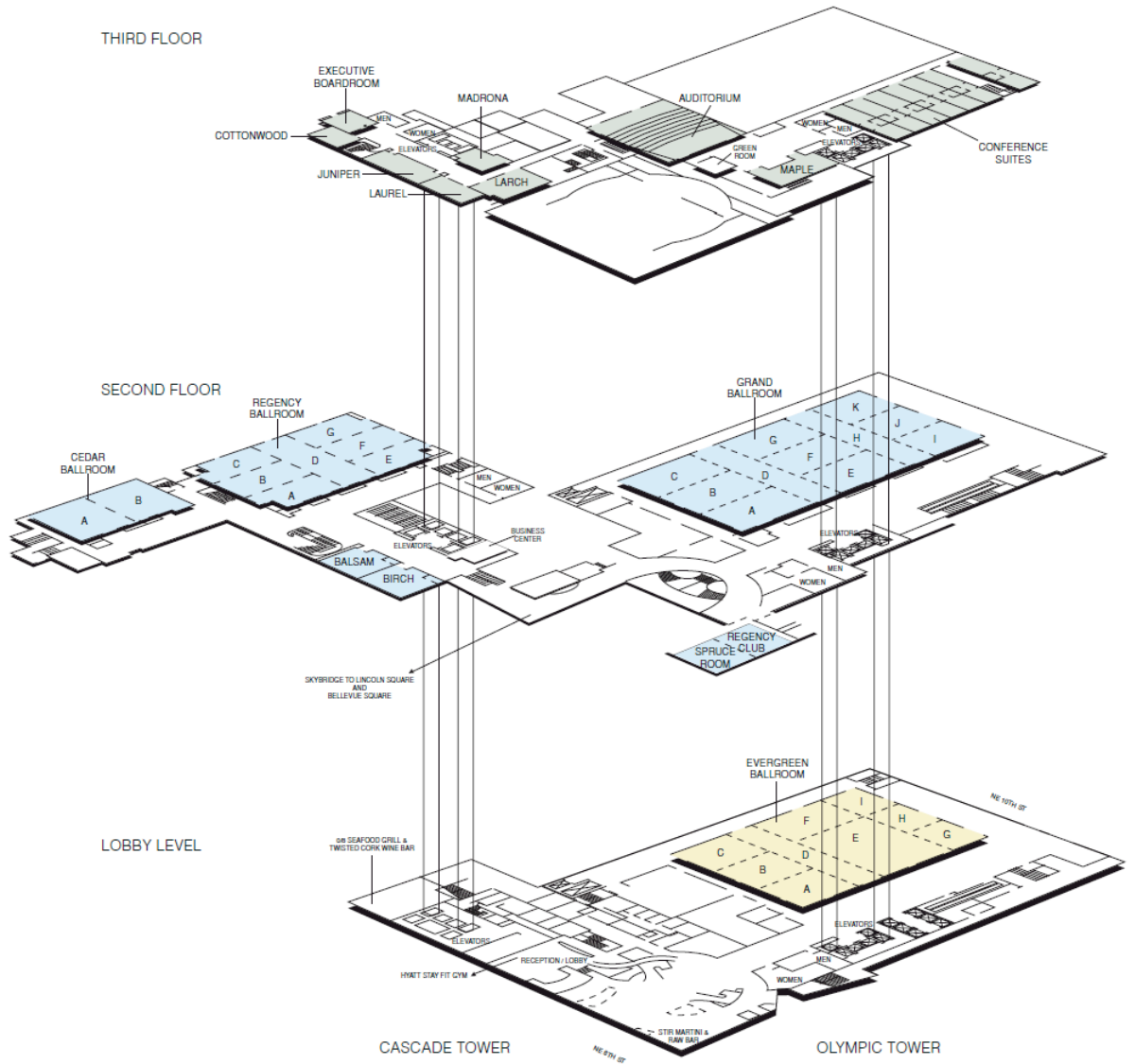

Dining and Entertainment in the immediate vicinity of the Hyatt Regency Bellevue



BELLEVUE PLACE

- 1** Suite
Coming Soon
- 2** Zen Express
Second Level
- 3** Needs Deli | Mercantile
Second Level
- 4** Tully's Coffee
- 5** Daniel's Broiler
21st Floor
- 6** Twisted Cork
- 7** Joey Bellevue

LEGEND

- Restaurants
- Restaurants with Live Music
- Entertainment
- Quick Service

All locations are on the First Level, unless noted.



LINCOLN SQUARE

- 8** Maggiano's Little Italy
- 9** Din Tai Fung
Second Level
- 10** Paddy Coyne's Irish Pub
- 11** The Parlor Billiards & Ultralounge
Third Level
- 12** McCormick & Schmick's Seafood Restaurant
- 13** Tully's Coffee
- 14** Lucky Strike Lanes & Power Play
Second Level
- 15** Lincoln Square Cinemas
Third Level
- 16** Pearl Bar & Dining
- 17** Earls Kitchen & Bar
- 18** Cypress Lounge
- 19** Palomino

BELLEVUE SQUARE

- 20** Red Robin
- 21** Dog in the Park
- 22** The Cheesecake Factory
- 23** Boom Noodle
- 24** Blue C Sushi
- 25** Munchbar
Second Level
- 26** Piano Bash
Second Level
- 27** Ristorante Luciano
- 28** Z'Tejas Southwestern Grill
Second Level
- 29** P.F. Chang's China Bistro
- 30** Starbucks at The Lodge
- 31** Pagliacci Pizza
Second Level
- 32** Ruth's Chris Steak House
Second Level
- 33** Nordstrom Marketplace Café
Third Level
- 34** Nordstrom ebar
- 35** Nordstrom Grill
Second Level
- 36** Nordstrom ebar (outdoors)
Second Level
- 37** The Greek Kitchen
- 38** Taco Del Mar
- 39** Tully's Coffee
Second Level
- 40** Mrs. Field's Cookies
Second Level
- 41** Jamba Juice
- 42** Red Mango
- 43** ricenroll
Second Level
- 44** Auntie Anne's
Second Level
- 45** Cinnabon
- 46** Popcorn Pavilion
- 47** Baskin-Robbins Ice Cream
- 48** McDonald's
- 49** Villa Fresh Italian Kitchen
Second Level
- 50** World Wrapps
Second Level
- 51** Starbucks
Second Level
- 52** Specialty's Café & Bakery
- 53** PinkaBella Cupcakes
Third Level

DOWNTOWN BELLEVUE



-  Hotels
-  Shopping
-  Downtown Shopping and Business District
-  Pedestrian Skybridge
-  Parking (public, pay and free of charge)

Map courtesy of City of Bellevue

ICML 2011 is gratefully acknowledging the generous support of its sponsors

Platinum Sponsors



Gold Sponsors



Silver Sponsors



Supporting Sponsors

